



## Electrical

<b>Impedance</b>	50 ohm
<b>Frequency Range</b>	DC-18 GHz
<b>VSWR</b>	1.25 max
<b>Input Avg Power</b>	2W@ 25°C ambient, derating linearly to 0.2W at 100°C

## Mechanical & Environmental

<b>Connector Body</b>	Non-magnetic Gold plated beryllium copper(nickel-free under-plating)
<b>Center Contact</b>	Non-magnetic Gold plated beryllium copper(nickel-free under-plating)
<b>Resistor Material</b>	Thin Film
<b>Net Weight</b>	Approx 3g
<b>Operating Temperature</b>	4 K to +125°C

## Dimensions(mm)

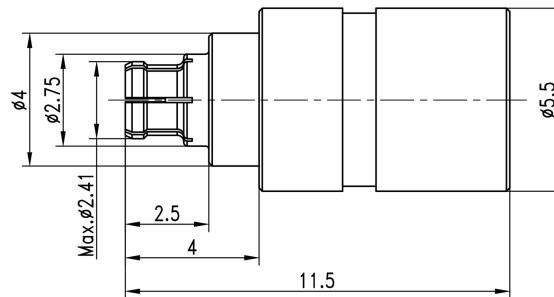

## Typical Test Data

