

Drawing(mm)

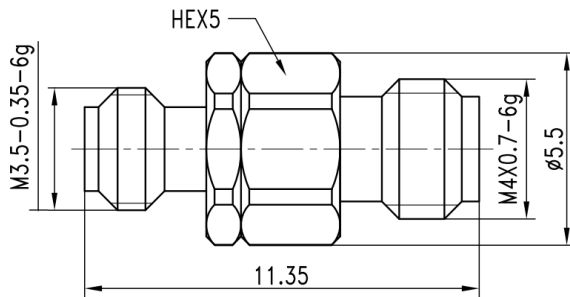

Electrical & Environmental

| | |
|------------------------|----------------|
| Impedance | 50 ohm |
| Frequency Range | DC-110 GHz |
| VSWR | 1.35 max |
| Operating Temp | -55°C to +85°C |

Material

| | |
|-----------------------|------------------------------|
| Connector Body | Passivated stainless steel |
| Center Contact | Gold plated beryllium copper |
| Insulator | PEI |