

SRFS TELEINFRA

Get connected with us:



BNC female to BNC female bulkhead RF Adaptor

Model No.- SRFS-BH-BNCF-BNCF-4

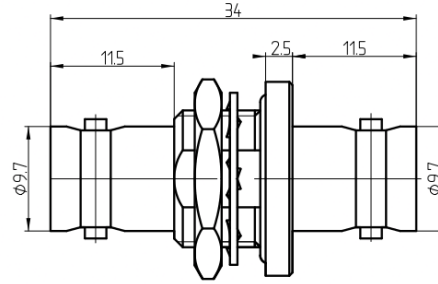

Mounting Hole

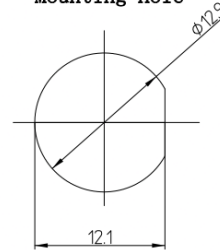

Electrical Specifications		
Frequency range	DC-4GHz	
Characteristic impedance	50Ω	
VSWR	≤ 1.17:1	
Type	Bulkhead, feedthrough	
Connector Type	BNC(f) to BNC(f)	
Insulation Resistance	≥5000MΩ	
Center Contact Resistance	≤3MΩ	
Outer Contact Resistance	≤2MΩ	
Durability (matings)	≥500	
Mechanical & Environmental Specifications		
Operating Temperature	-45°C to + 85°C	
ROHS Compliant	Yes	
Material & Finish		
Body	Brass	Nickel-plated
Pin contacts	Phosphor Bronze	Gold-plated
Coupling Nut	Brass	Nickel-plated
Washer	Bronze	Nickel-plated
Gasket	Silicon rubber	
Insulators	Teflon	

Add: plot no 10 shiv Vihar a block Najafgarh Sahibi river road Vikas Nagar Uttam Nagar new delhi-110059

+91 7838349349 info@srfsteleinfra.in, sales@srfsteleinfra.in, srfsteleinfra@gmail.com

www.srfsteleinfra.in, www.srfsteleinfra.com



SRFS Teleinfra | All specifications are subject to change. Unless otherwise stated, all specifications are nominal. SRFS reserves the right to make such changes as required. It may be necessary to make modifications to the part and/or the documentation of the part to implement improvements. See www.srfsteleinfra.in for the most current information. Revised: 19 Jan 2023