

Waveguide to Coaxial Adapter Part No: SRFS140WCASKPC

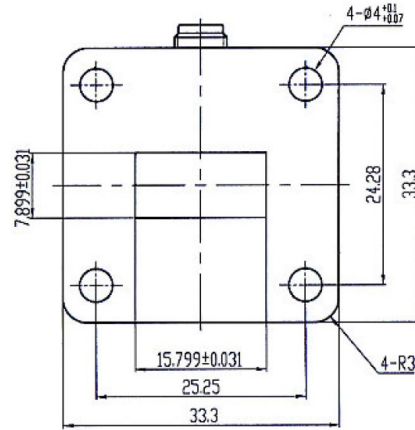
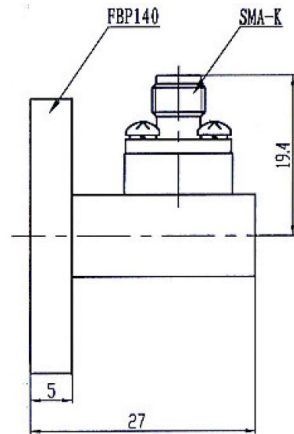

Electrical & Mechanical Specifications	
Frequency range	11.9-18 GHz
VSWR (Max)	1.25
Insertion Loss (Max)	0.3 dB
Waveguide type	WR62
Flange type	FBP140 (Cover)
Connector type	SMA Female
Material	Copper
Inside finish	Silver plating
Outside finish	Anticorrosion grey paint