

# SRFS TELEINFRA

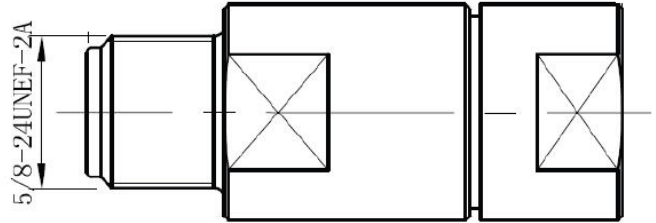

## N Female Straight For 1/2 in Feeder Cable (SRFS-CONN-1/2F)



Electrical & Mechanical Specifications	
Interface Standard	IEC61169-54
Impedance	50 ohms
Frequency	DC-6Ghz
VSWR	≤1.15@DC-3G,1.20 @3G-6G
PIM3(@2x43dBm)	≤-160 dBc
Dielectric withstanding voltage	≥1500V RMS, 50Hz, at sea level
Dielectric Resistance	≥5000MΩ
Center contact resistance	≤1.15mΩ
Outer contact resistance	≤1.0mΩ
Durability	≥500 mating cycles
Watertightness	IP67
Salt-fog test	96h
ROHS compliance	Full ROHS compliant
Temperature (°C)	-40 to +85
Material Data & Requirements	
Body	Brass, Tri-alloy plated
Center conductor	Brass, Ag plated
Insulator	PTFE



Plot no 10 Shiv Vihar A Block Najafgarh Nala Road Vikasnagar Uttam Nagar New Delhi-110059

+91-9027232570, +91-8800726650 [info@srfsteleinfra.in](mailto:info@srfsteleinfra.in), [info@srfsteleinfra.com](mailto:info@srfsteleinfra.com)

[www.srfsteleinfra.in](http://www.srfsteleinfra.in)