

## 2 in 1 out Hybrid Combiner-698-4000MHz N-F

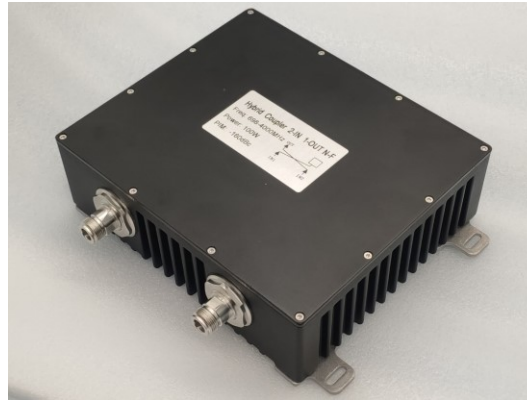

Electrical and Mechanical Specifications	
Frequency range	698MHz -4000MHz
Insert loss	$\leq 3.8\text{dB}$
In-band ripple	$\leq 1.0\text{dB}$
VSWR	$\leq 1.30$
Isolation	$\geq 20\text{dB}$
PIM (IM3) @ 1800 MHz	$\leq -160\text{dBc}@2\times 43\text{dBm}$
Power	$\geq 300\text{W}$
Impedance	50 $\Omega$
Connector	N-F
Degree of protection	IP65
Appearance	Black paint
Relative humidity	$\leq 95\%$
Operating Temperature( $^{\circ}\text{C}$ )	$-35^{\circ}\text{C}$ to $+75^{\circ}\text{C}$

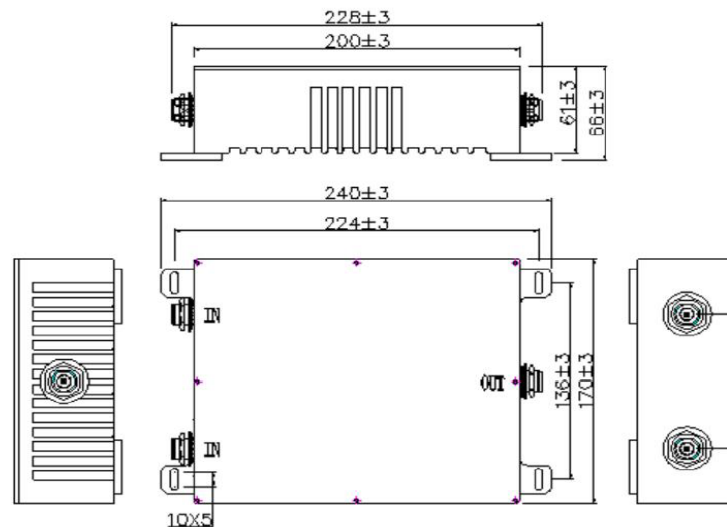

Plot no 10 Shiv Vihar A Block Najafgarh Nala Road Vikasnagar Uttam Nagar New Delhi-110059

+91-9027232570, +91-7838349349 [info@srfsteleinfra.in](mailto:info@srfsteleinfra.in), [info@srfsteleinfra.com](mailto:info@srfsteleinfra.com)

[www.srfsteleinfra.in](http://www.srfsteleinfra.in)