

## Waveguide to Coaxial Adapter (End-Launch) SRFS320WECASKPC

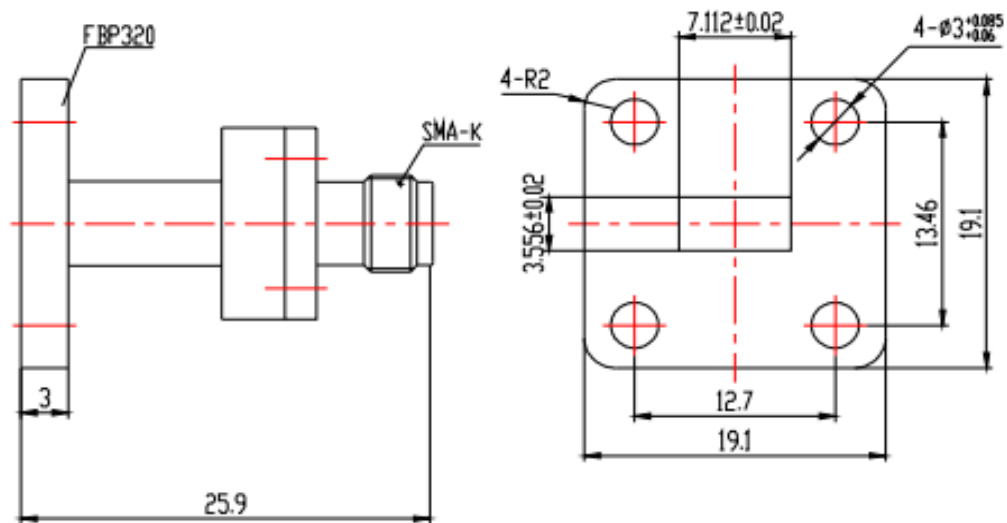

### Mechanical Specifications

Waveguide type	WR28
Material	Copper
Flange type	FBP320
Connector Type	SMA Female
Inside Finish	Gold plating

### Electrical Specifications

Frequency Range	26.5-40 GHz
VSWR (Max)	1.35