

Waveguide to Coaxial Adapter (End-Launch) SRFS220WECA2.92KPC

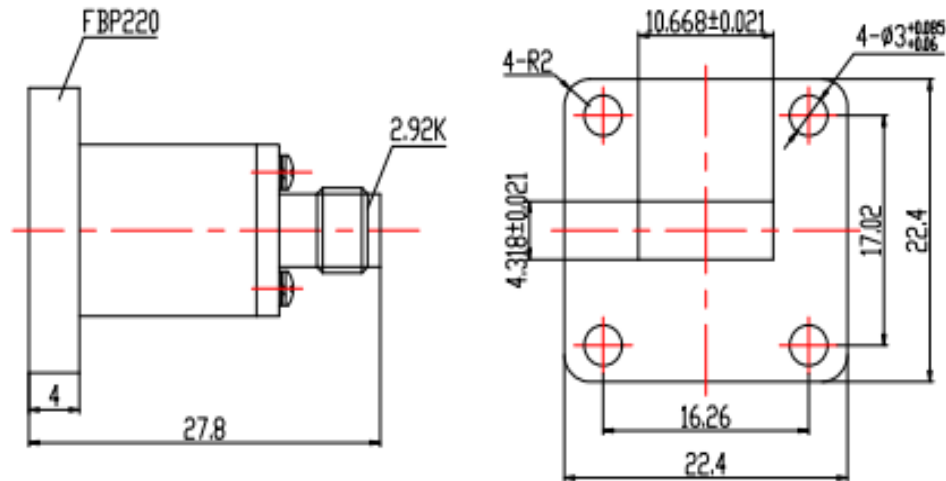

Mechanical Specifications	
Waveguide type	WR42
Material	Copper
Flange type	FBP220 (Cover)
Connector Type	2.92mm Female
Finish	Gold plating
Electrical Specifications	
Frequency Range	17.6-26.7 GHz
VSWR (Max)	1.25