

SRFS TELEINFRA

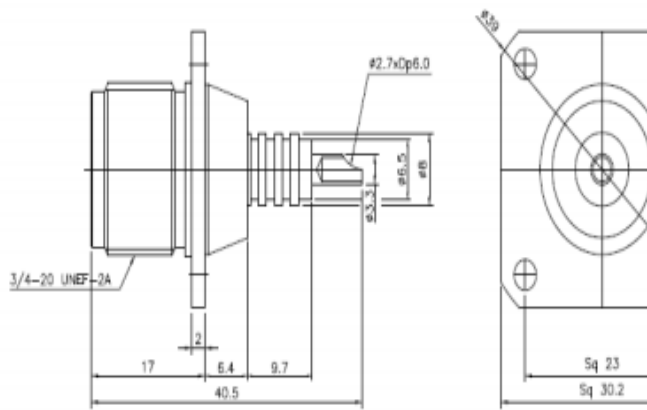

HN Female 4H (30.2 Sq.) Flange Solder Pot (SRFS-HNF4H30.2)



Electrical & Mechanical Specifications		
Characteristics Impedance	50 ohm	
Frequency Range	DC 6GHz	
VSWR	≤1.10 @DC-3GHz; ≤1.35 @DC-6GHz;	
Dielectric Withstanding Voltage	≥2500V RMS,50Hz,at sea level	
Working Voltage	1000Vrms,50 Hz at sea level	
Contact Resistance	Center Contact ≤ 1.0 mΩ Outer Contact ≤ 0.25 mΩ	
Dielectric Resistance	≥5000MΩ	
Durability Mating cycles	≥500	
Material & Plating		
	Material	Plating
Body	Brass	Ni
Insulator	PTFE	-
Center Conductor	Beryllium Copper	Au
Environmental		
Temperature Range	-55°C~+155°C	
RoHS	Compliant Yes	
Waterproof Rate	IP 68	



Plot no 10 Shiv Vihar A Block Najafgarh Nala Road Vikasnagar Uttam Nagar New Delhi-110059

+91-9027232570, +91-8800726650 info@srfsteleinfra.in, info@srfsteleinfra.com

www.srfsteleinfra.in