

4.3/10 Female (solder) Connector For 1/2" Superflexible Cable

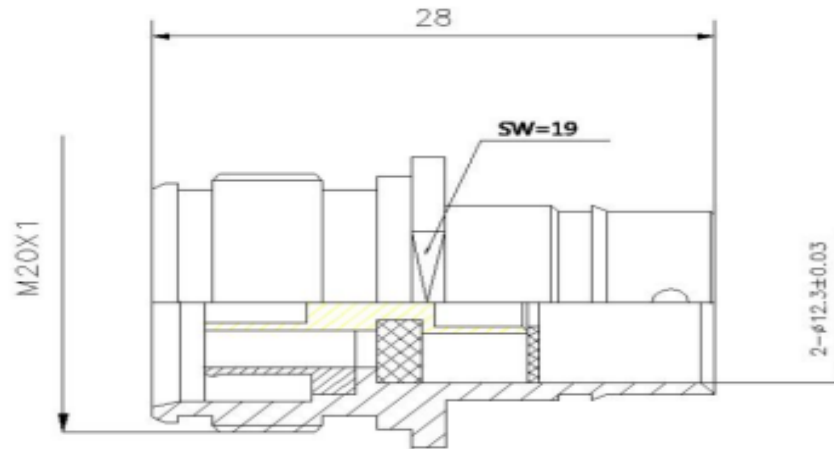

Electrical & Mechanical Specifications		
Characteristic Impedance	50 ohm	
Frequency Range	DC- 12 GHz	
VSWR	≤1.10@DC-3000MHz	
Contact Resistance	Center contact ≤1mΩ Outer contact ≤1mΩ	
Dielectric withstanding Voltage	>2500V RMS, 50Hz, At sea Level	
Dielectric Resistance	≥5000MΩ	
Durability	Mating cycles ≥100	
Material & Plating		
	Material	Plating
Body	Brass	Tri-alloy
Insulator	PTFE	—
Center conductor	Phosphor bronze	Ag
Environmental		
Temperature Range	-40°C~+85°C	
RoHs Compliant	Yes	