

25W 3.8GHZ N Male -165dbc Low PIM Termination

Product Description:

25W 3.8GHZ N Male -165dbc Low PIM Termination

25 Watts N Male Low PIM -163dbc -165dbc RF Load Termination

Dummy load/Low PIM Termination/Load is a device used to stop some port as a RF power load when testing other RF products or stop the RF power radiation when some port is not used at present , the theory is matching similar impedance to real device that will be connected to the RF System. Dummy load also will absorb some power and getting heating when RFA system works, so when use dummy load to stop some port in the RF system, pay attention to the power handling , otherwise may be over-heated .

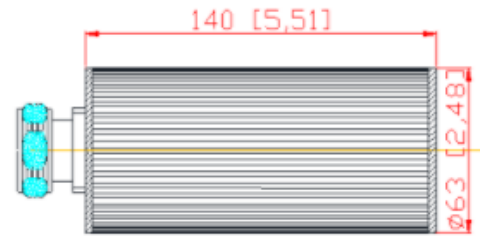

Mechanical & Electrical Specifications

Mechanical & Electrical Specifications	
Part Number	SRFS-LD-4G-25W-INm-R-160
Operating Frequency (GHz)	0-4
Impedance (Ohm)	50
VSWR	≤1.25
IM3 (dBc @ 2×37dBm)	-160
Application	Indoor
Operating Temperature (°C)	-40 ~ + 80
Interface	N Male
Handling Power (Watt, max)	25
Dimension (mm)(L×W×H, excl connector)	140 × Ø63
Net Weight (g)	715 ± 20
Packing Dimensions (mm,L×W×H)	210 × 65 × 65
Packing Carton Size (mm,L×W×H)	345 × 345 × 220
ROHS Compliance	Yes

Plot no 10 Shiv Vihar A Block Najafgarh Nala Road Vikasnagar Uttam Nagar New Delhi-110059

+91-9027232570, +91-8800726650 ✉ info@srfsteleinfra.in, info@srfsteleinfra.com

🌐 www.srfsteleinfra.in

SRFS TELEINFRA



25W 3.8GHZ N Male -165dbc Low PIM Termination



Plot no 10 Shiv Vihar A Block Najafgarh Nala Road Vikasnagar Uttam Nagar New Delhi-110059

+91-9027232570, +91-8800726650  info@srfsteleinfra.in, info@srfsteleinfra.com

 www.srfsteleinfra.in