

1.6 / 5.6 MALE U LINK CONNECTOR

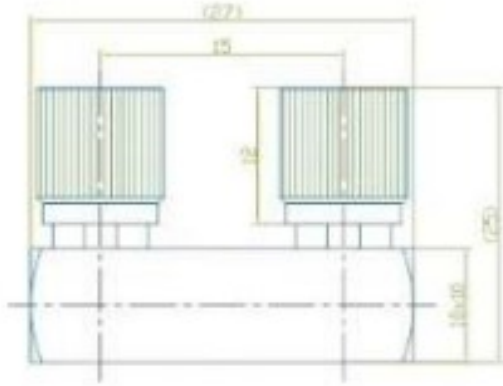

ELECTRICAL&MECHANICAL SPECIFICATIONS		
Impedance	75 Ω	
Frequency	DC – 1 GHz	
VSWR	≤ 1.25 @ DC 1 GHz	
Dielectric Withstanding Voltage	≥ 1000 Vrms at Sea Level	
Dielectric Resistance	≥ 10000 M Ω	
Contat Resistance (Center Contact)	≤ 4 M Ω	
Contact Resistance (Outer Contact)	≤ 2 M Ω	
Mating cycles	≥ 500 times	
MATERIAL&PLATING		
	Material	Plating
Body	Brass	Ni
Insulator	PTFE	-
Center Conductor	Phosphor Bronze	Au
Resilient Contact	Phosphor Bronze	Au
Coupling Nut	Brass	Ni
Ferrule	Annealed Copper	Ni
ENVIRONMENTAL SPECIFICATIONS		
Temperature Range	- 40 $^{\circ}$ C ~ +85 $^{\circ}$ C	
RoHS Compliant	Yes	